



**T.** LUCE<sup>®</sup> LIGHT  
AS AN EXPRESSION  
OF LIFE

DUETTO SYSTEM



## **DUETTO**

Ultimate slim, perfect style

Innovative slim linear connecting system, a perfect combination between tracks and LED fixtures. Not only emphasizing on characteristics and rapid installation of the modules, also creates simple and clean appearance. Unique designed spot, panel and downlight modules are available for multitasking lighting requirement to the area. This is a perfect solution to maximize lighting creativity.



ETL Approved

# DUETTO



LIGHT  
AS AN EXPRESSION  
OF LIFE

## DUETTO TRACK

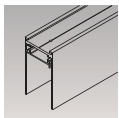

TL-SDT Surface mounted & Pendant track P.9

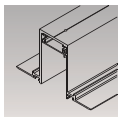

TL-SDR Trimless recessed track P.9

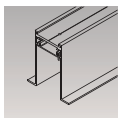

TL-SDF Trim recessed track P.9

## DUETTO MODULES

		Series name	LED Consumption	Lumen	
		DUETTO - K	11W 22W 33W	1000 (lm) 2000 (lm) 3000 (lm)	P.16
		DUETTO - P	9.2W 18.4W 27.5W	472 (lm) 1197 (lm) 1428 (lm)	P.18
		DUETTO - W	11W	462 (lm)	P.20
		DUETTO - S	6.4W 12.7W	626 (lm) 1114 (lm)	P.22
		DUETTO - GR	4.6W	214(lm)	P.24
		DUETTO - GL	4.6W	399 (lm)	P.26
		DUETTO - C	6.4W	626 (lm)	P.28
		DUETTO - KC	22W	2000 (lm)	P.30
		DUETTO - KS	11W	1000 (lm)	P.32



## DUETTO

Slim linear connecting system, can be recessed, surface mounted or pendant. Suitable for all kinds of interior environment.

The LED modules are designed with simple linear style, each series perform its own function, making lighting design easier than ever.

# DUETTO

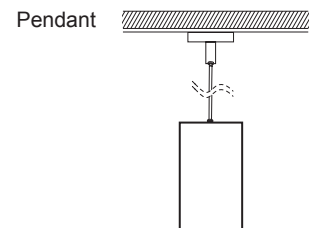
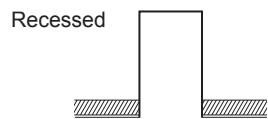
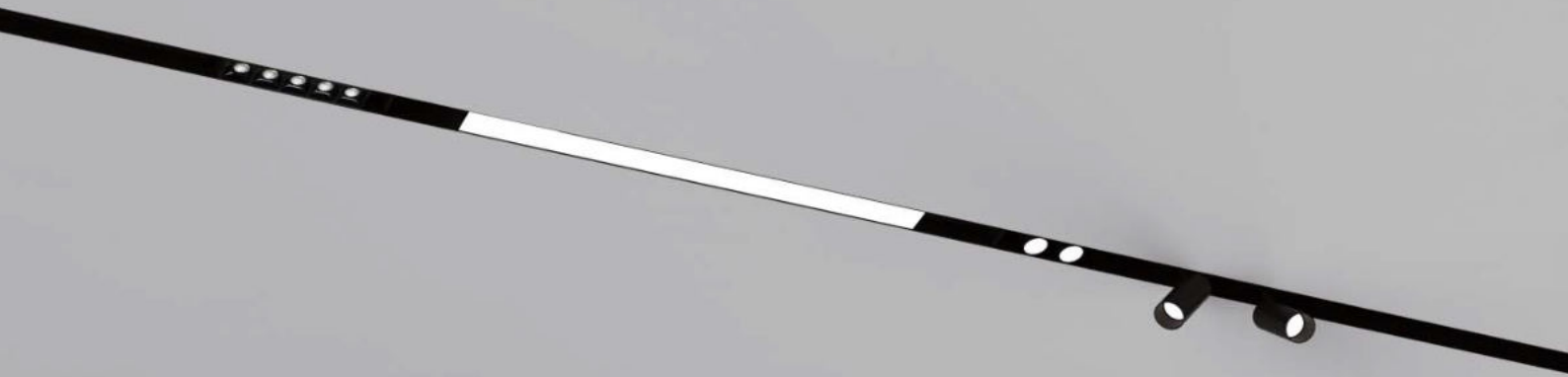

# DUETTO

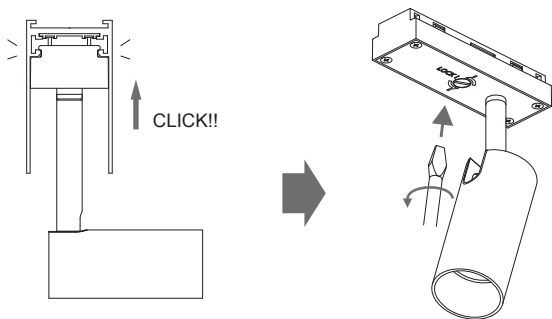

LED fixture installation is designed to be simple and convenient, just plug and play, tools-free, significant savings on installation and maintenance.

The track cover can be moved or cut to fit with the LED fixture to make overall appearance succinct.

### Track section

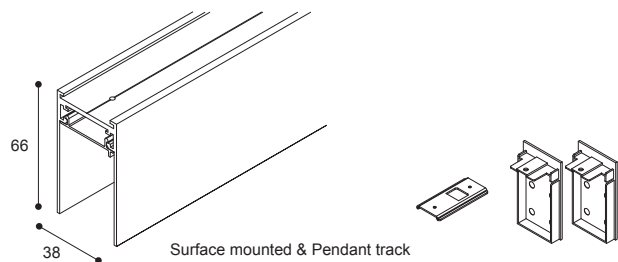

### Product performance

Article number	L
TL-SDT-01	1500mm
TL-SDT-02	2100mm
TL-SDT-03	2500mm

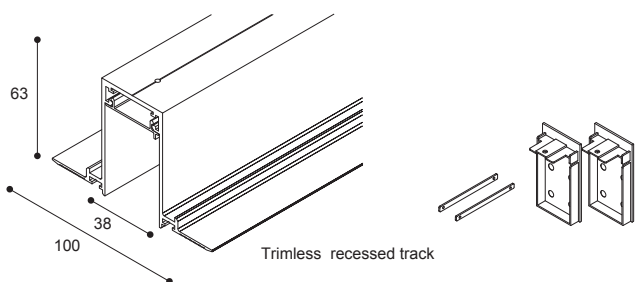

Article number	L
TL-SDR-01	1500mm
TL-SDR-02	2100mm
TL-SDR-03	2500mm

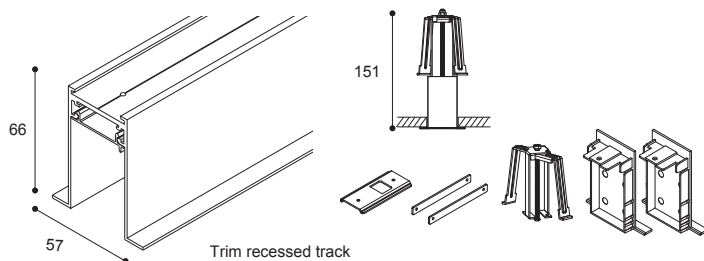

Article number	L
TL-SDF-01	1500mm
TL-SDF-02	2100mm
TL-SDF-03	2500mm

Colours   
Black White

### Accessories

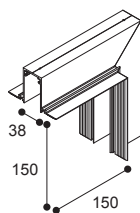

Article number: TL-SDR-04  
Type : Trimless recessed vertical corner

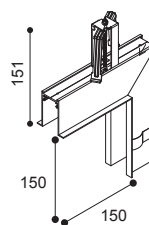

Article number: TL-SDF-04  
Type : Trim recessed vertical corner

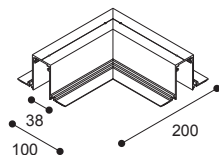
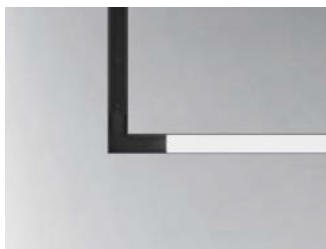

Article number : TL-SDR-05  
Type : Trimless recessed horizontal corner

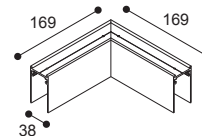

Article number : TL-SDT-05  
Type : Surface mounted & pendant horizontal corner

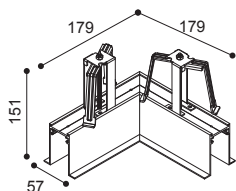

Article number : TL-SDF-12  
Type : Trim recessed horizontal corner

# DUETTO

## INSTALLATION GUIDE

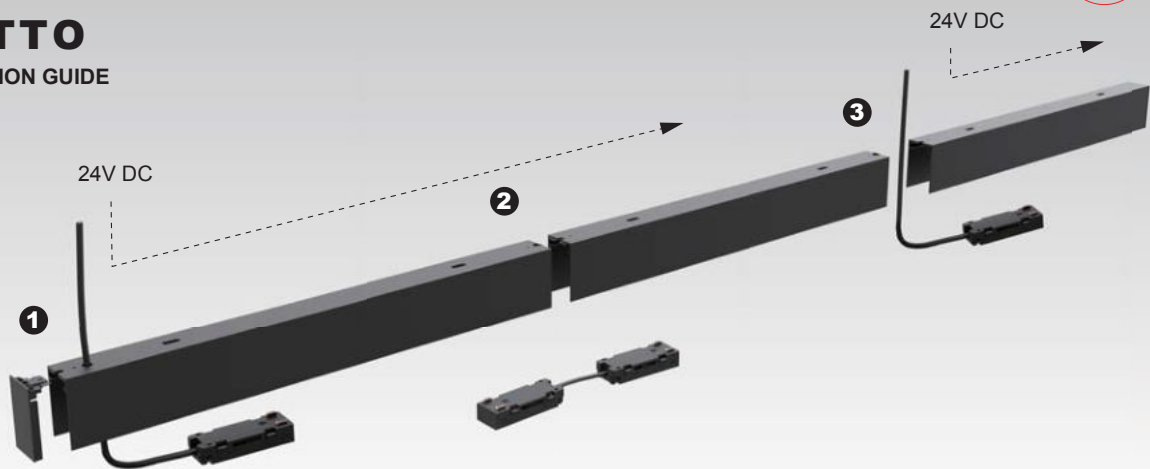

### APPLICATION – connecting power in different conditions for continuous connection

#### 1 Single Power, Single Track

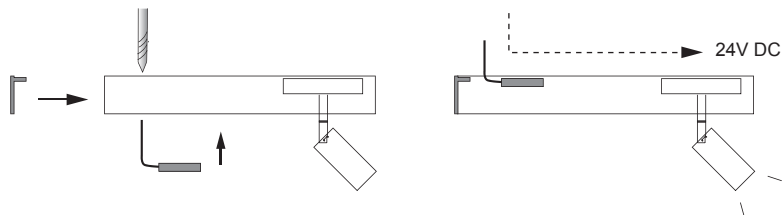
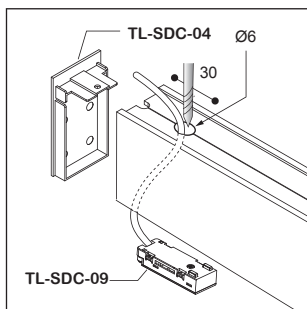

#### 2 Single Power, Multiple Tracks

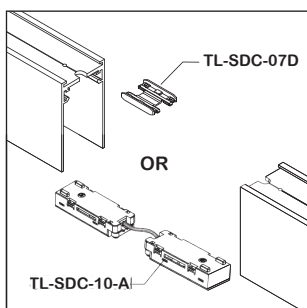

##### TL-SDC-07D

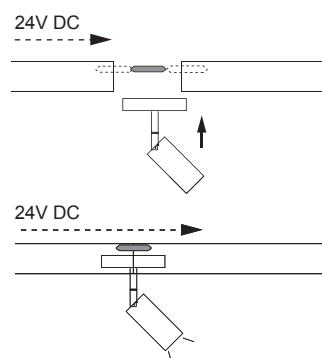

##### TL-SDC-10-AM

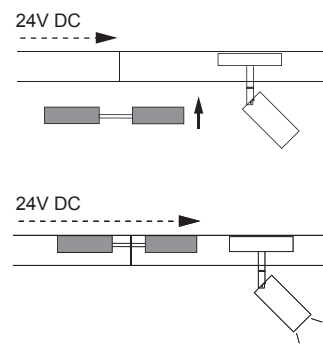

Using circuit joint (TL-SDC-07D or TL-SDC-10-AM) to connect between tracks

#### 3 Multiple Powers, Multiple Tracks

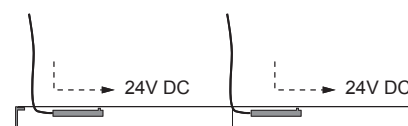
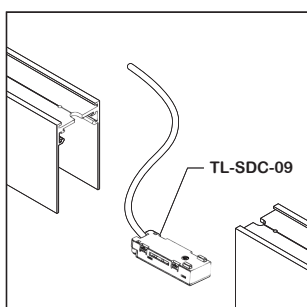

Using power joint (TL-SDC-09) to connect more drivers

## ACCESSORIES

### Connections

---

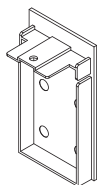

Article number : TL-SDC-04  
Type : Surface mounted & pendant  
& trimless recessed end cap  
without power cord

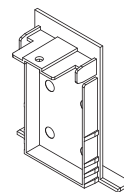

Article number : TL-SDC-04A  
Type : Trim recessed end cap  
without power cord

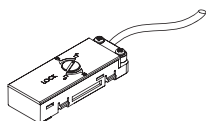

Article number : TL-SDC-09  
Type : Power joint  
Length : 200cm

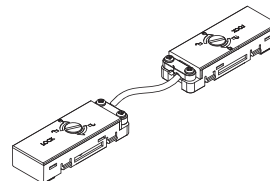

Article number : TL-SDC-10-AM  
Type : Circuit joint

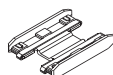

Article number : TL-SDC-07D  
Type : New circuit joint

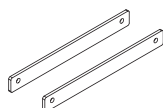

Article number : TL-SDC-05  
Type : Trim recessed & surface  
mounted reinforced joint

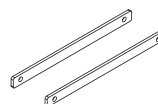

Article number : TL-SDC-05A  
Type : Trimless recessed  
reinforced joint

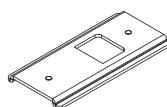

Article number : TL-SDC-06  
Type : Surface mounted & Pendant  
reinforced plate

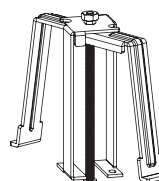

Article number : TL-SDI-10  
Type : Trim recessed clip

### Pendant

---

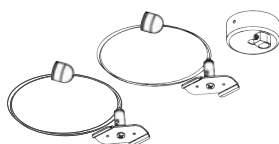

Article number : TL-SDI-05  
Type : Pendant kit for power connection  
without power cord  
Length : 150cm



Article number : TL-SDI-06  
Type : Pendant kit without  
power cord  
Length : 150cm

# DUETTO

## Application Illustration

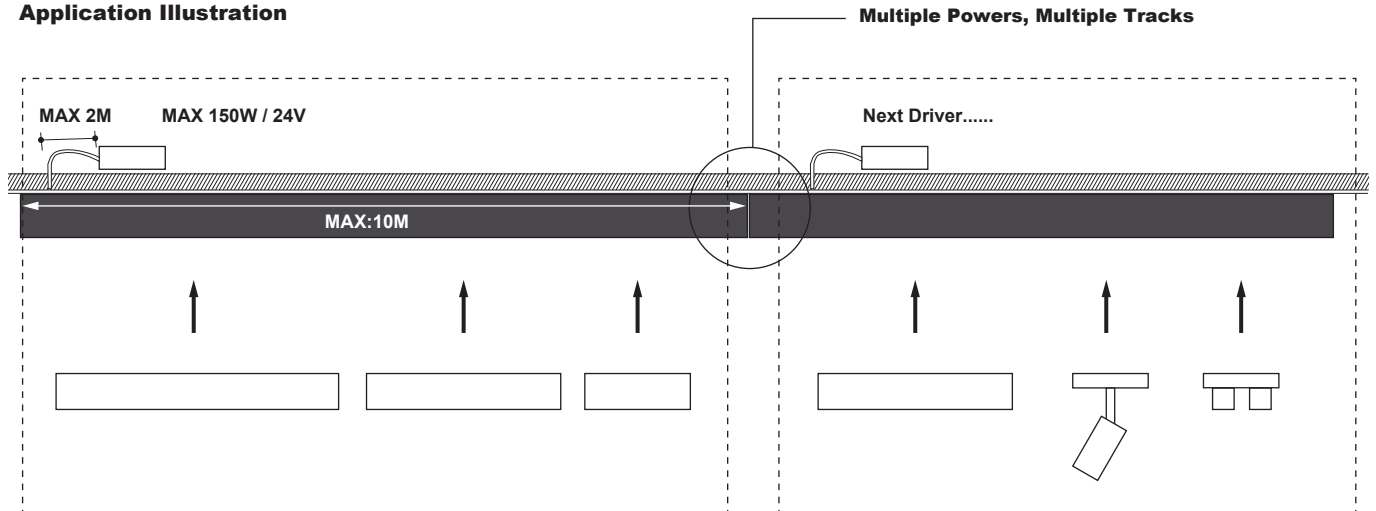

## NOTE:

1. Max wattage linkable per loop for 24VDC is 150W.
2. Max length of track linkable per loop is 10M , and the max cable length between driver and track is 2M.
3. Dimming modules are compatible to TL-PWM dimming driver only.
4. To use drivers not on recommended list , it require compatibility test before installation.
5. Tracks allows continuous linkable without limitation, also can divide into sections to light up individual area, making lighting application easy as 123.
6. Minimum voltage per loop is 22VDC (measure at the end of the loop), under 22VDC per loop might cause abnormal.
7. Calculating max wattage connection, save 20% buffer for linear modules, and 25% buffer for other modules.
8. Use driver not in the recommended list might cause module flickering, unstable dimming and/or noise, even causing module failure.
9. When multiple drivers are use in the connection, make sure the connector without circuit is used to divide the loop.
10. When installation tracks (pipes), make sure measuring the voltage from TL-SDC-09/TL-SDC-10-AM with the driver connected first, without modules, to see if the voltage is 24VDC, then measure the track & TL-SDC-09/SDC-10-AM to see if the voltage drop is  $\leq 0.1V$ , if the voltage drop is over 0.1V, make sure the connector is secured properly, warpage is not allowed in the connection, also check the cleanliness of the copper connector, copper connector can be cleaned using alcohol.

## Driver Installation

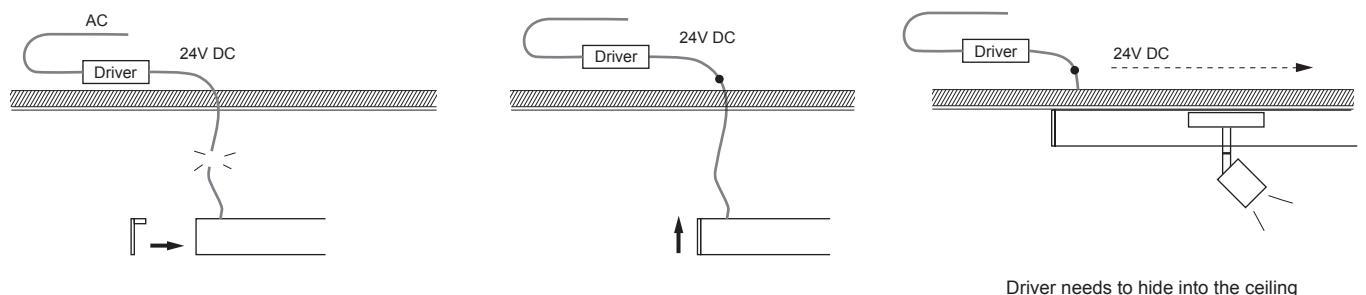

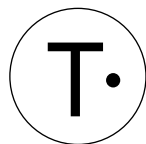



# DUETTO





# DUETTO - K

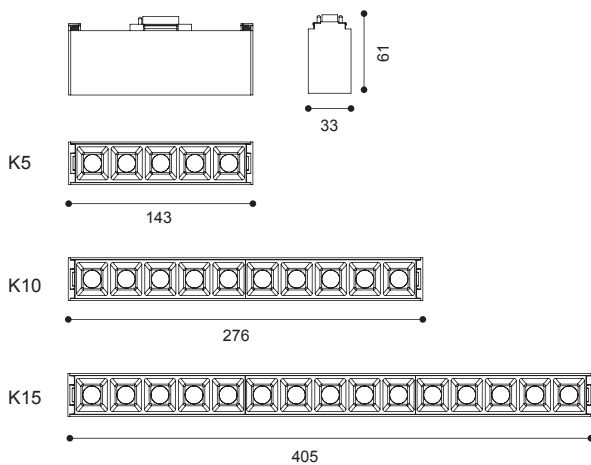

## K5

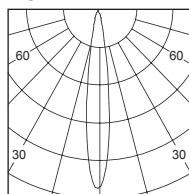

h(m)	D(m)	E(lx)
15°		
1.0	0.25	7598
2.0	0.51	1899
3.0	0.76	844
4.0	1.02	474
5.0	1.28	303

## K10

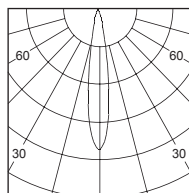

h(m)	D(m)	E(lx)
15°		
1.0	0.29	11173
2.0	0.59	2793
3.0	0.88	1241
4.0	1.18	698
5.0	1.47	446

## K15

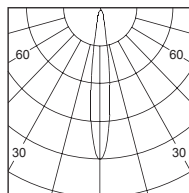

h(m)	D(m)	E(lx)
15°		
1.0	0.25	20028
2.0	0.51	5007
3.0	0.76	2225
4.0	1.02	1252
5.0	1.28	801

- Colours  Black  White
- Baffle :  Black  White  Piano black

### Product performance

#### DUETTO - K5

Article number	LED Consumption	Voltage	Lumen	Beam Angle	CCT/CRI	Locking Type
TL-1817.406A-V	11W	24V DC	1000 (lm)	15°/30°/40°	30/90+	Push

#### DUETTO - K10

Article number	LED Consumption	Voltage	Lumen	Beam Angle	CCT/CRI	Locking Type
TL-1817.406B-V	22W	24V DC	2000 (lm)	15°/30°/40°	30/90+	Push

#### DUETTO - K15

Article number	LED Consumption	Voltage	Lumen	Beam Angle	CCT/CRI	Locking Type
TL-1817.406C-V	33W	24V DC	3000 (lm)	15°/30°/40°	30/90+	Push



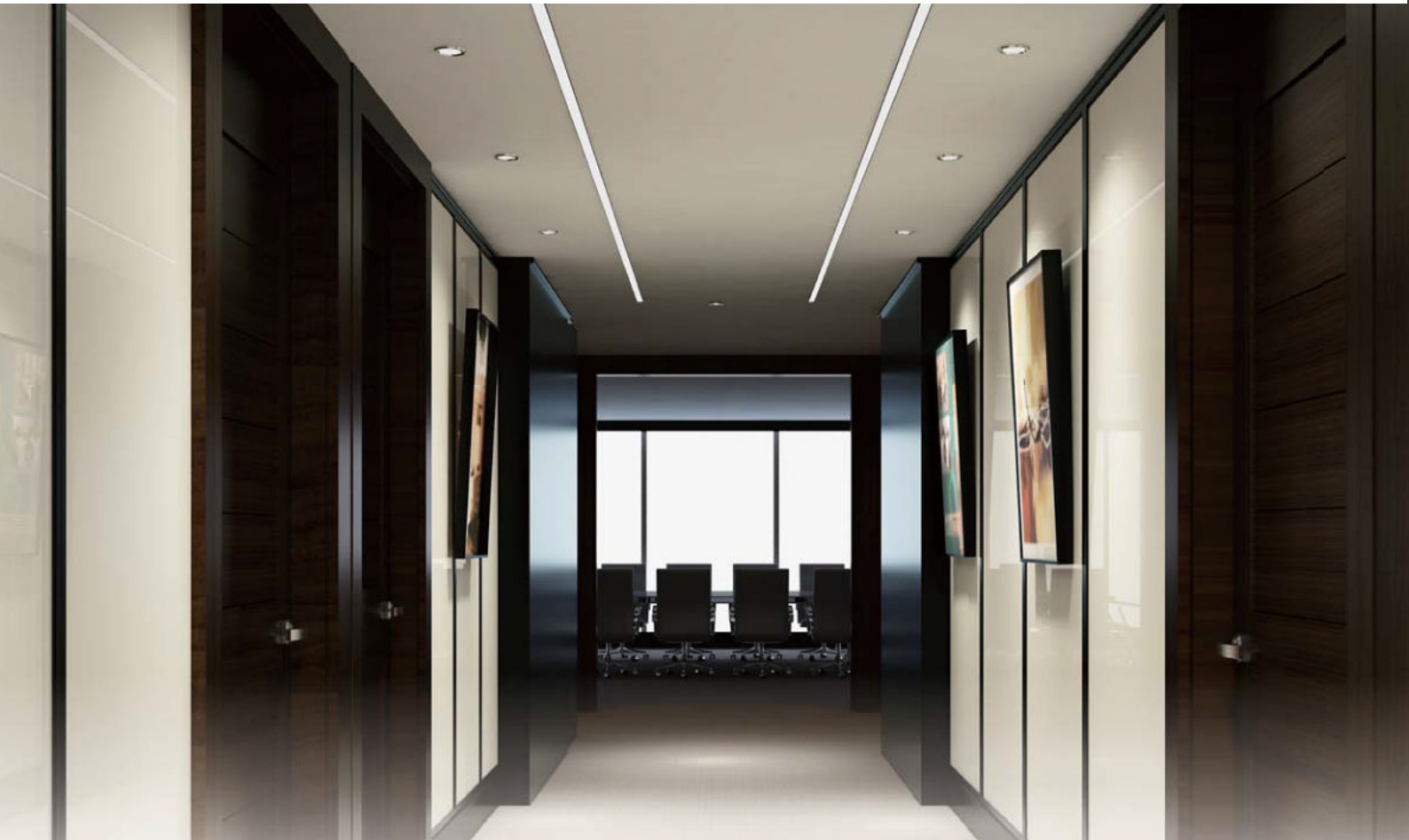

## DUETTO - P Seamless Installation

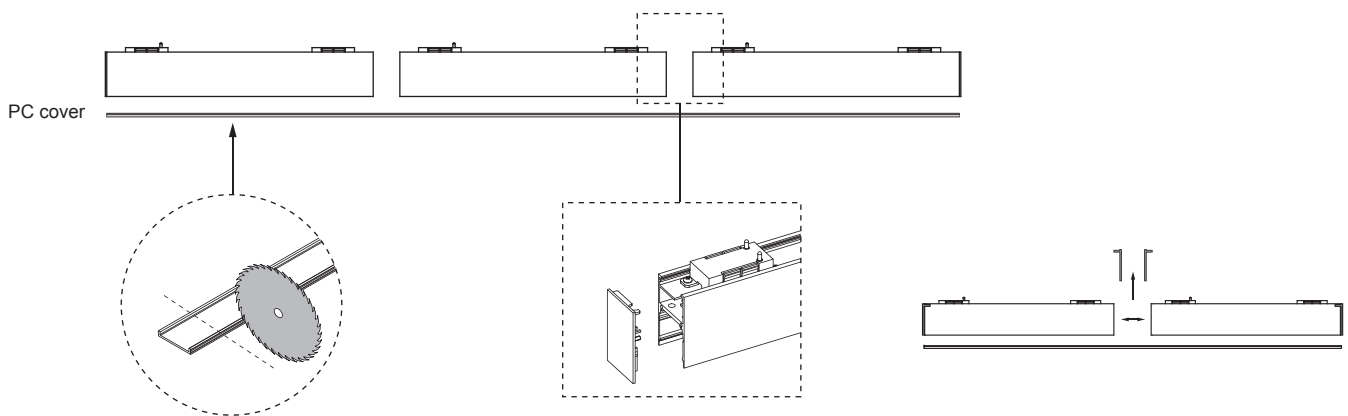

PC cover can be cut into required length

Remove the end cap from SLIMDUET-P module, the modules can be installed next to each other, then use longer PC cover to make seamless appearance.

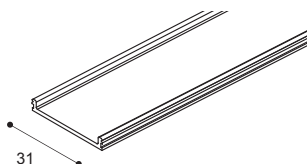

Colours White

### Product performance

Article number	L
SDE-01	4000mm
SDE-02	15000mm

# DUETTO - P

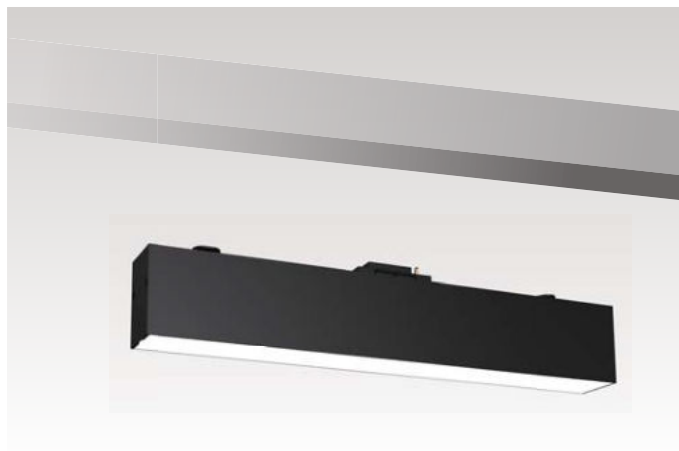
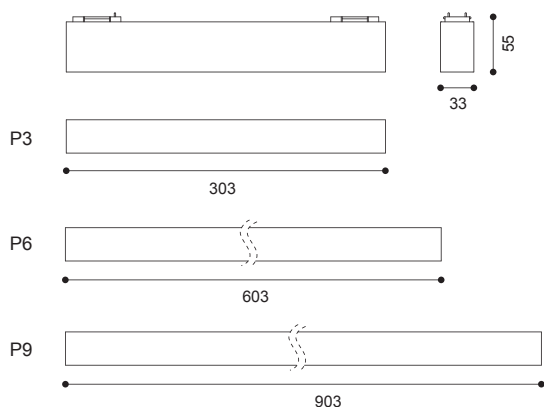

## P3

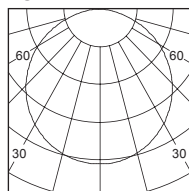

h (m)	D (m)	E (lx)
115°		
1.0	3.01	164
2.0	6.02	41
3.0	9.04	18
4.0	12.05	10
5.0	15.06	6

## P6

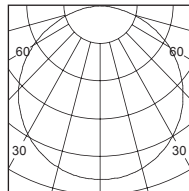

h (m)	D (m)	E (lx)
115°		
1.0	3.03	415
2.0	6.06	103
3.0	9.09	46
4.0	12.13	25
5.0	15.16	16

## P9

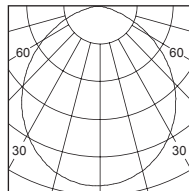

h (m)	D (m)	E (lx)
115°		
1.0	2.36	538
2.0	4.73	134
3.0	7.10	59
4.0	9.47	33
5.0	11.84	21

Colours Black White

### Product performance

#### DUETTO-P3

Article number	LED Consumption	Voltage	System Lumen	Beam Angle	CCT/CRI	Locking Type
TL-1817.410A-V	9.2W	24V DC	472 (lm)	115°	30/80+	Twist

#### DUETTO-P6

Article number	LED Consumption	Voltage	System Lumen	Beam Angle	CCT/CRI	Locking Type
TL-1817.410B-V	18.4W	24V DC	1197 (lm)	115°	30/80+	Twist

#### DUETTO-P9

Article number	LED Consumption	Voltage	System Lumen	Beam Angle	CCT/CRI	Locking Type
TL-1817.410C-V	27.5W	24V DC	1428 (lm)	115°	30/80+	Twist



# DUETTO - W

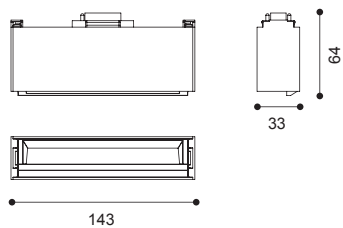

1817.407A-V

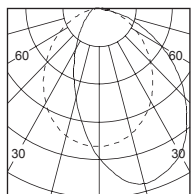

h(m)	D(m)	E(lx)
Wallwash		
1.0	1.35	251
2.0	2.71	62
3.0	4.07	27
4.0	5.43	15
5.0	6.79	10

- Colours ● ○  
 Black White
- Baffle : ●  
 Black

## Product performance

Article number	LED Consumption	Voltage	System Lumen	Beam Angle	CCT/CRI	Locking Type
TL-1817.407A-V	11W	24V DC	462 (lm)	wallwash	30/90+	Push





# DUETTO - S

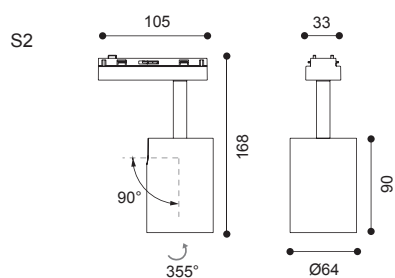
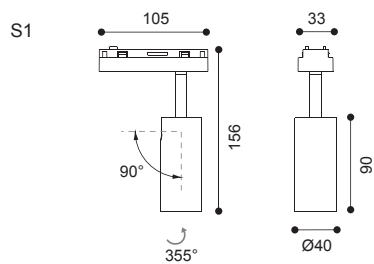

TL-1617.407-V

h(m)	D(m)	E(lx)
15°		
1.0	0.25	3342
2.0	0.50	835
3.0	0.75	371
4.0	1.00	208
5.0	1.25	133

h(m)	D(m)	E(lx)
20°		
1.0	0.34	1834
2.0	0.68	458
3.0	1.02	203
4.0	1.37	114
5.0	1.71	73

TL-1617.411-V

h(m)	D(m)	E(lx)
16°		
1.0	0.28	4946
2.0	0.56	1236
3.0	0.84	549
4.0	1.13	309
5.0	1.41	197

h(m)	D(m)	E(lx)
21°		
1.0	0.37	3278
2.0	0.75	819
3.0	1.13	364
4.0	1.51	204
5.0	1.89	131

h(m)	D(m)	E(lx)
35°		
1.0	0.63	1190
2.0	1.26	297
3.0	1.89	132
4.0	2.53	74
5.0	3.16	47

- Colours  Black  White
- Baffle :  Black  White  Copper

## Product performance

### DUETTO - S1

Article number	LED Consumption	Voltage	Lumen	Beam Angle	CCT/CRI	Locking Type
TL-1617.407-V	6.4W	24V DC	626 (lm)	15°/20°	30/90+	Twist

### DUETTO - S2

Article number	LED Consumption	Voltage	Lumen	Beam Angle	CCT/CRI	Locking Type
TL-1617.411-V	12.7W	24V DC	1114 (lm)	16°/21°/35°	30/90+	Twist

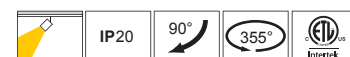



# DUETTO - GR

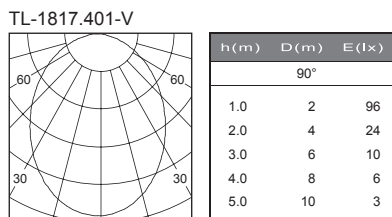
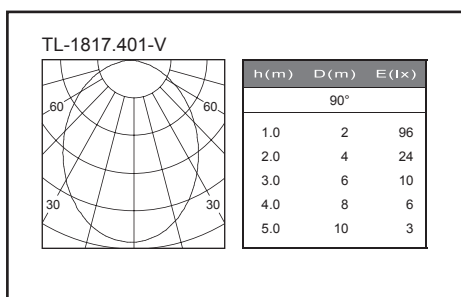
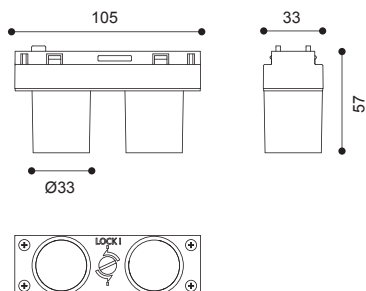

Colours  Black  White

## Product performance

Article number	LED Consumption	Voltage	System Lumen	Beam Angle	CCT/CRI	Locking Type
TL-1817.401-V	4.6W	24V DC	214 (lm)	90°	30/90+	Twist





# DUETTO - GL

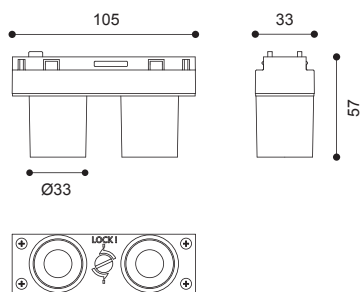

TL-1617.409A

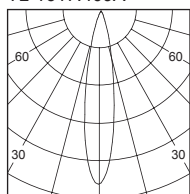

h(m)	D(m)	E(lx)
19°		
1.0	0.34	2290
2.0	0.68	572
3.0	1.02	254
4.0	1.36	143
5.0	1.70	91

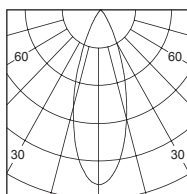

h(m)	D(m)	E(lx)
35°		
1.0	0.62	753
2.0	1.25	188
3.0	1.88	83
4.0	2.51	47
5.0	3.14	30

- Colours    
 Black White
- Baffle :     
 Black White Piano black

## Product performance

Article number	LED Consumption	Voltage	Lumen	Beam Angle	CCT/CRI	Locking Type
TL-1617.409A-V	4.6W	24V DC	399 (lm)	19°/35°	30/90+	Twist





# DUETTO - C

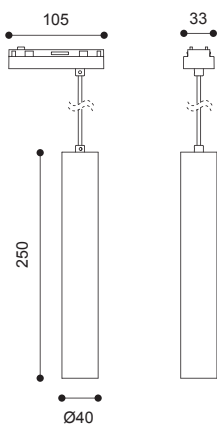

TL-1617.410

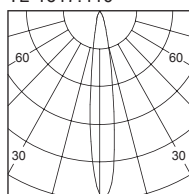

h(m)	D(m)	E(lx)
10°		
1.0	0.25	3417
2.0	0.51	854
3.0	0.76	379
4.0	1.02	213
5.0	1.27	136

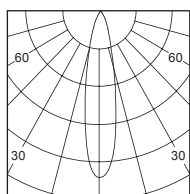

h(m)	D(m)	E(lx)
20°		
1.0	0.37	1755
2.0	0.74	438
3.0	1.12	194
4.0	1.49	109
5.0	1.86	70

- Colours  Black  White
- Baffle :  Black  White  Copper

## Product performance

Article number	LED Consumption	Voltage	Lumen	Beam Angle	CCT/CRI	Locking Type
TL-1617.410-V	6.4W	24V DC	626 (lm)	10°/ 20°	30/90+	Twist





# DUETTO - KC

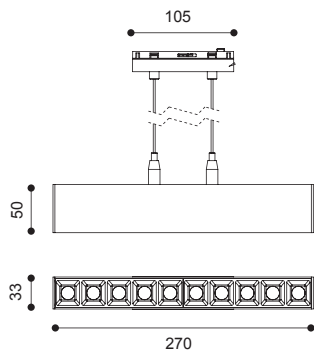

## TL-1817.411-V

h(m)	D(m)		E(lx)	h(m)	D(m)		E(lx)	h(m)	D(m)		E(lx)
	15°	25°			40°						
1.0	0.26	0.40	12704	1.0	0.40	0.68	6526	1.0	0.68	3318	
2.0	0.52	0.81	3176	2.0	0.81	1.36	1632	2.0	1.36	829	
3.0	0.78	1.22	1412	3.0	1.22	2.04	725	3.0	2.04	368	
4.0	1.05	1.62	794	4.0	1.62	2.72	407	4.0	2.72	207	
5.0	1.31	2.03	508	5.0	2.03	3.40	261	5.0	3.40	132	

- Colours  Black  White
- Baffle :  Black  White  Piano black

### Product performance

Article number	LED Consumption	Voltage	Lumen	Beam Angle	CCT/CRI	Locking Type
TL- 1817.411-V	22W	24V DC	2000 (lm)	15°/25°/40°	30/90+	Twist





# DUETTO - KS

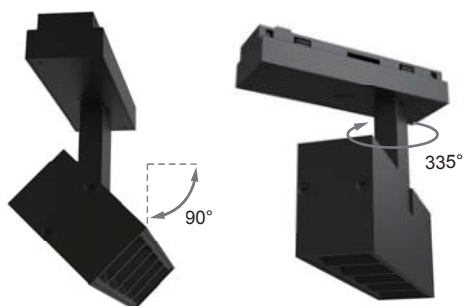
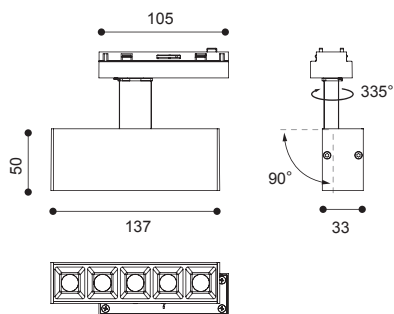

TL-1817.413

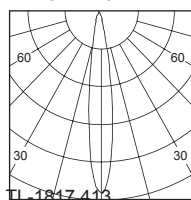

h (m)	D (m)	E (lx)
	15°	
1.0	0.25	7253
2.0	0.51	1813
3.0	0.77	805
4.0	1.03	453
5.0	1.29	290

- Colours  Black  White
- Baffle :  Black  White  Piano black

## Product performance

Article number	LED Consumption	Voltage	Lumen	Beam Angle	CCT/CRI	Locking Type
TL-1817.413-V	11W	24V DC	1000 (lm)	15°/30°/40°	30/90+	Twist

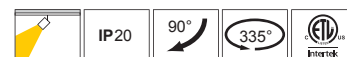

# OFFICES

## EUROPE

T-Luce Italia srl  
Viale Giacomo Matteotti 15, Firenze 50121, Italy

europa@t-luce.com  
+39 3281425503

## MIDDLE EAST

Tecno Hub 2, 2nd floor Office 212,  
Dubai, Silicon Oasis (UAE)

middleeast@t-luce.com  
+971 526627708

## ASIA

2263 Pasong Tamo Extension,  
Magallanes, Makati City

asia@t-luce.com  
+632 8893 2403



[info@t-luce.com](mailto:info@t-luce.com)  
[www.t-luce.com](http://www.t-luce.com)

IMPORTED & DISTRUBUTED BY:

T-Luce Italia srl  
Viale Giacomo Matteotti 15 - Firenze 50121