

Urban

STREET LIGHTING

DECORATIVE

LIGHT
AS AN EXPRESSION
OF LIFE





INDEX

4 - 9TLA-LED27
10 - 11TLA-LED27B
12 - 13TLA-LED27D
14 - 15TLA-LED27F
16 - 17TLA-LED27H | TLA-LED27J
18 - 19ACCESSORY OPTIONS
21OFFICES



Product features

ATLAS TLA-LED27 SERIES

ATLAS's distinctive aesthetics is conceived to satisfy any architecture firm and environmental planner. Which is Elegant, pure, clear and timeless that redefines and modernizes the shapes and edges of the city centre and historical districts street lighting. Super-quality materials used in the HERA and faultless manufacturing excellence delivers exceptional and reliable performance with minimal maintenance for many years. Perfectly engineered optical systems and full luminaire precise sizing design, enabling all parts and components in HERA working efficiently, securing the most reliable package over lifetime and beyond, maximizing its performance and granting colour stability.

Key Advantage:

- New design unique appearance
- Tool free installation and maintenance
- UP to ME1 lighting class application
- Dark sky friendly and no upward light, UP to G6 glare rating.
- Flexible and intelligent drivers for smart city
- Low wind area and drop protector
- IP66 and IK09

Application:

- Residential areas
- Road and street lighting
- High way, Airport, Parking place
- Pathway & Pedestrians
- Smart city option

PARAMETER	TECHNICAL DATA
Type	ATLAS SERIES
Light source	SMD LED Module
Color temperature	4000 K as standard. Optional 2700K, 3000K & 5000K & 5700K. Amber LED available
Color stability	3 or 5 MacAdam steps for all standard LED colors
Color Rendering Index	>70 or >80 (neutral white and cool white)
Luminous Flux (led flux @ Ta=25C outdoor)	from 2100 to 14400 lm
Power	from 15W up to 120W
Luminaire efficiency	120-140 lm/W
Lumen Maintenance (L70)	≥ 100,000 hours
Lumen Maintenance (L90B10)	≥ 40,000 hours
Constant lumen output (CLO)	as requirement
Optics Material	PC
Optical Cover	Tempered Glass (5mm)
ULOR (%)	0% for flat glass versions
Spigot diameter	60 mm, 76 mm
Control inputs	0-10V/DALI
Electrical class	class I and class II
Color	RAL7024 as standard (RAL or AKZO Future colors available)
IP rating	IP66
IK rating	IK09 (according to IEC - EN 62262)
Operating temperature range	-40°C < Ta ≤ 50°C
Driver thermal protection	yes
Surge protection	4kV (10kV available as an option)
Options	mini Photocell and NEMA socket, including cable
Certifications	CE CB ENEC(in certification)
Material	ADC12 / Lower copper contents



Optics Available

Street series 2X2

HERA SERIES

LED Adapt

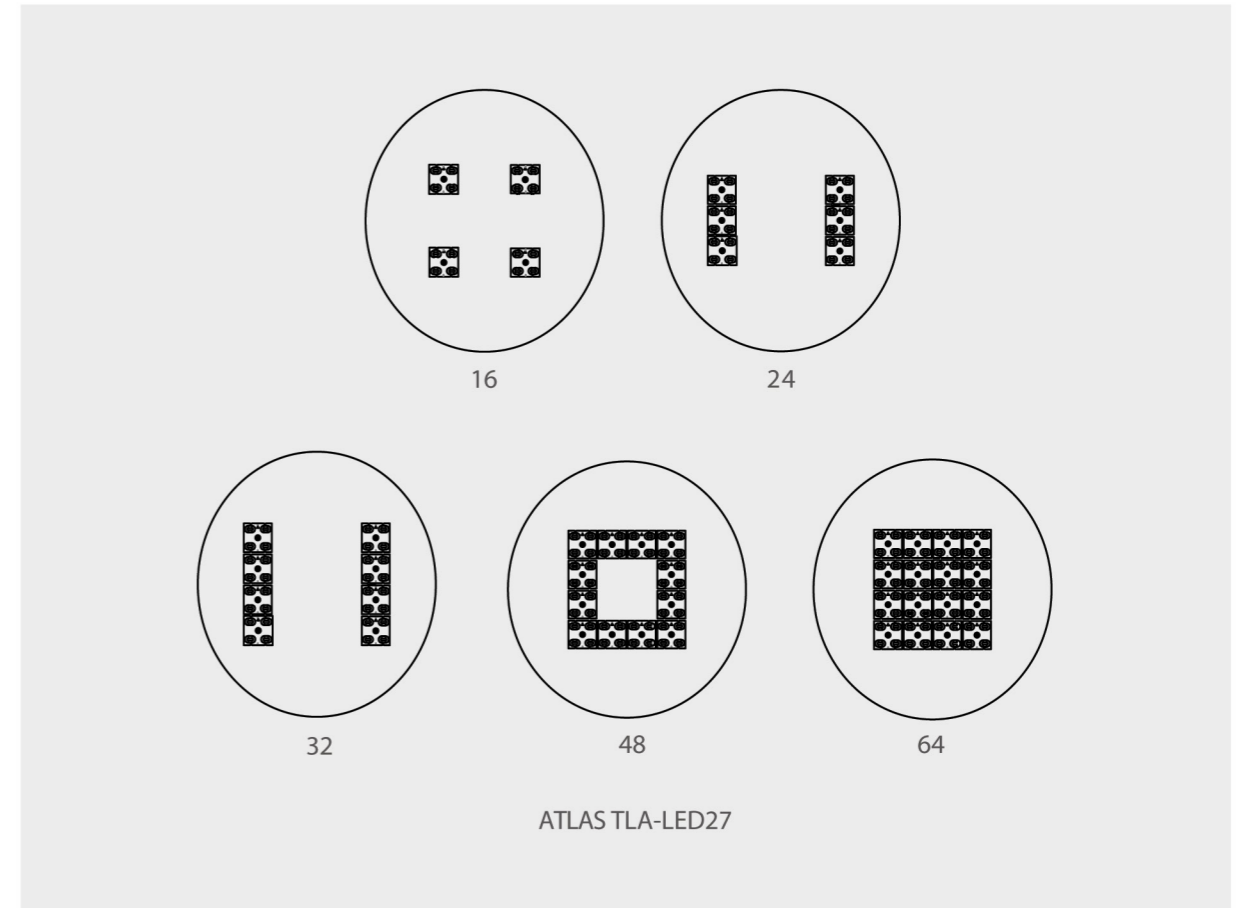
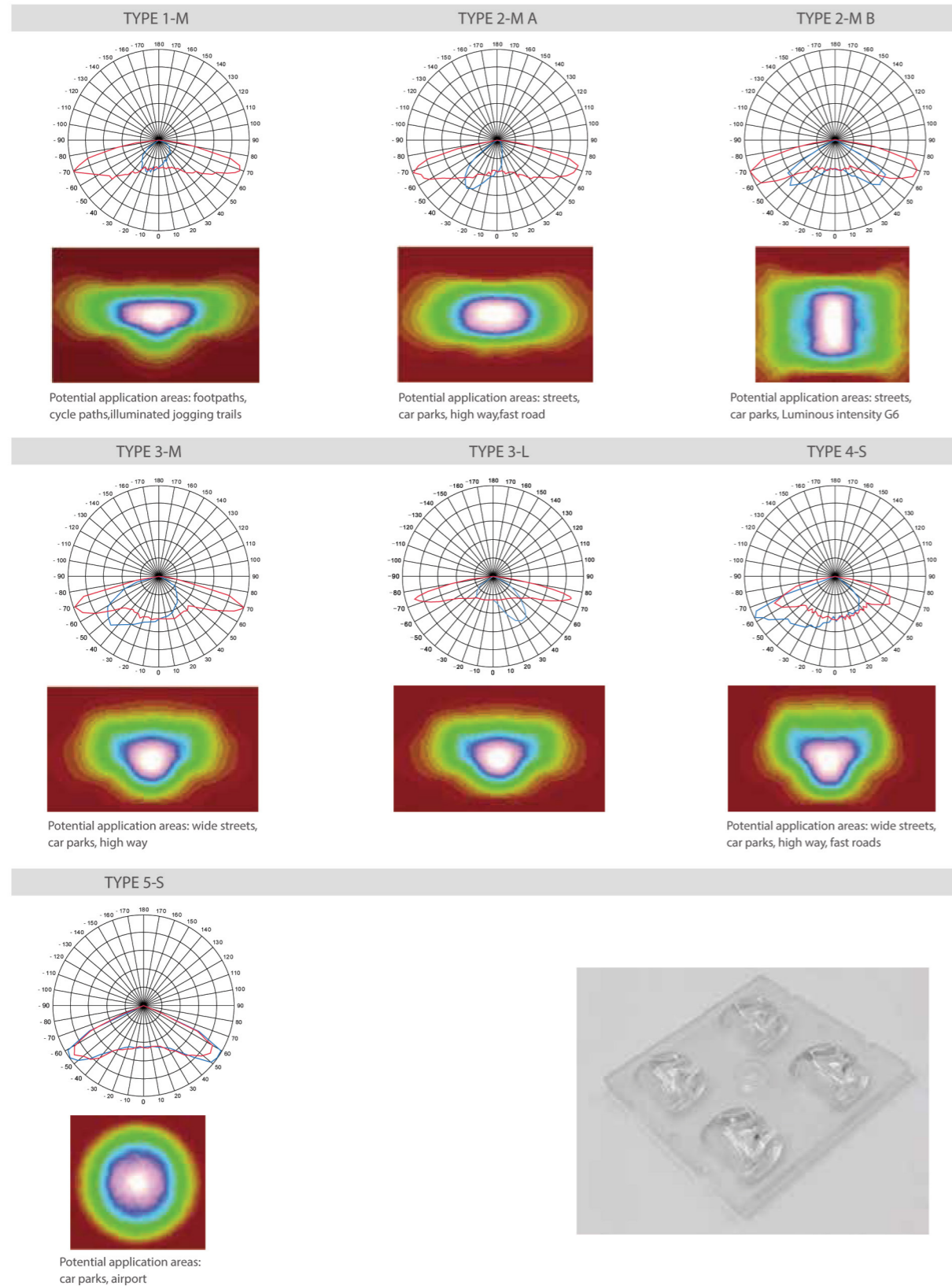

LEDS	POWER (W) MIN/MAX	LUXEON 5050 MAX(lm)	MIN(lm)	L90B10 at 25 ° IESNA TM-21-11	L70 at 25 ° IESNA TM-21-11
16	15-30	2100	3600	> 40000hrs	> 100000hrs
24	20-40	2800	4800	> 40000hrs	> 100000hrs
32	40-80	5600	9600	> 40000hrs	> 100000hrs
48	50-100	7000	12000	> 40000hrs	> 100000hrs
64	60-120	8400	14400	> 40000hrs	> 100000hrs



LUMILEDS

LUXEON 5050

High efficacy and lumens in a multi-die, high power package, enabling low system costs



Other options:
ATLAS TLA-LED27

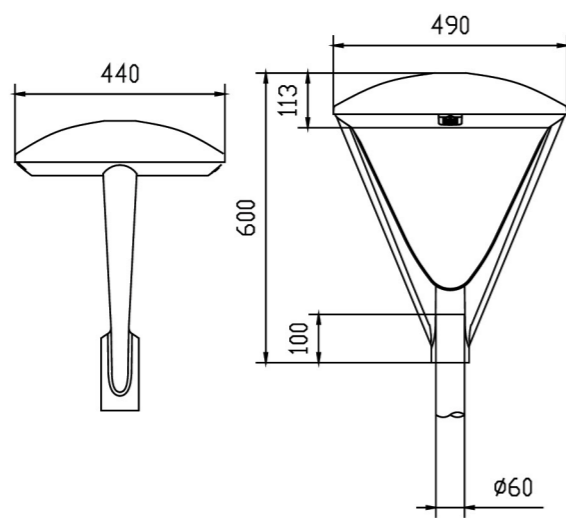

Other options:

ARIEL TLA-LED27B

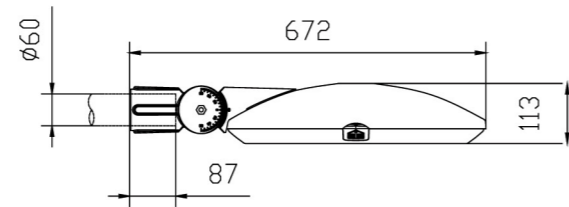
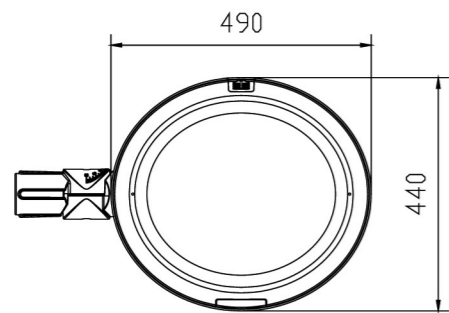

Other options:

LEONIDA TLA-LED27D

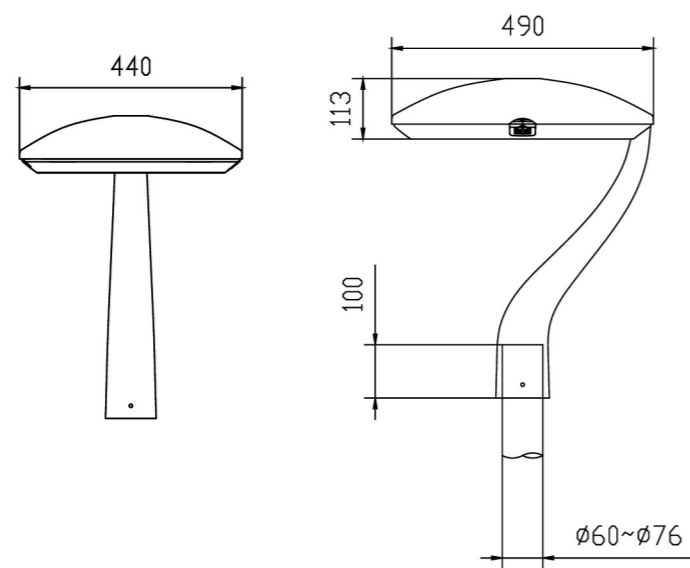

Other options:

THOMAS TLA-LED27F

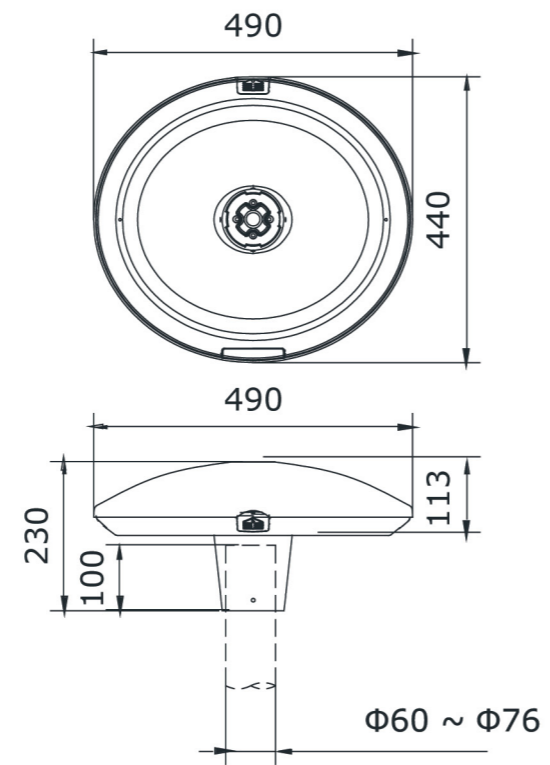

Other options:

HYPERION TLA-LED27H THEMIS TLA-LED27J



HYPERION TLA-LED27H



THEMIS TLA-LED27J



Accessories Options



Surge Protection device

Surge Protection device offers protection against lightning surges;
 Voltage Protection level up (L-N) $\leq 1,5$ kV
 Voltage Protection level up (L/N-PE) $\leq 2,0$ kV
 Uoc = 10 kV
 I max = 10 kA
 I nom = 5 kA



Surge Protection device

Maximum Discharge Current (Imax) 10kA, 8/20 μ s
 • Meets ANSI C136.2 Enhanced Level 10kV/5kA, IEEE C62.41.2 Location Category C Low Exposure and US Dept. of Energy MSSLC Model Spec.
 • Thermally Protected Varistor technology
 • Parallel and Series Connected SPD Options
 • IP66 Water-proof and Dust-proof



Shorting Cap

Standard: ANSI C136.10-1996



Photocell

Standard: ANSIC136.10-2010



Nema Socket

Standard : ANSI C136.10



Zhaga Connector

• Contacts rating: 1.5A, 30V (24V typical)
 • Meets 10kV dielectric withstand voltage to mounting surface
 • 4 pole contacts
 - Pin 1: 24Vdc
 - Pin 2: DALI (or DALI based protocol) -/common ground
 - Pin 3: DALI (or DALI based protocol) +
 - Pin 4: General I/O



Console adapter

Spigot size 60 - 76 mm



Wall mounting bracket

Spigot size 40 - 60 mm



Wall mounting bracket

Vertical



Microwave Motion Sensor

Detailed Product Description
 Operating Voltage:120-277Vac, 50/60Hz
 HF System:5.8GHz \pm 75MHz, ISM Wave Band
 IP Rating:IP65
 Rated Load:120Vac 4A Electronic/magnetic Ballast
 277Vac 3A Electronic/magnetic Ballast
 Operation Temperature: -25 \square ~ 55 \square
 Function:2 Step /3 Step Dimming/ On Off Function
 Mounting Height: 6-15m
 Cover Color: Blank Or White
 Hold Time: 5s/30s/1min/3min/5min/10min/20min/30min



Connector

10m cable with IP66 rated connector offers easy installation of the street luminaires.
 3 wire cable connector



Pre-installed cable sets

Pre-installed cables sets in the luminaire
 Diameter of the cable:
 3 x 1,5 mm - 0,5 m lenght
 3 x 1,5 mm - 5 m lenght
 3 x 1,5 mm - 6 m lenght
 3 x 1,5 mm - 8 m lenght
 3 x 1,5 mm - 10 m lenght
 3 x 1,5 mm - 12 m lenght
 3 x 1,5 mm - 18 m lenght



Pre-installed cable sets

Pre-installed cables sets in the luminaire
 Diameter of the cable:
 5 x 1,5 mm - 0,5 m lenght
 5 x 1,5 mm - 5 m lenght
 5 x 1,5 mm - 6 m lenght
 5 x 1,5 mm - 8 m lenght
 5 x 1,5 mm - 10 m lenght
 5 x 1,5 mm - 12 m lenght
 5 x 1,5 mm - 18 m lenght



LIGHT
AS AN EXPRESSION
OF LIFE

OFFICES

EUROPE

T-Luce Italia srl
Viale Giacomo Matteotti 15, Firenze 50121, Italy

europa@t-luce.com
+39 3281425503

MIDDLE EAST

Tecno Hub 2, 2nd floor Office 212,
Dubai, Silicon Oasis (UAE)

middleeast@t-luce.com
+971 42328303

ASIA

2263 Pasong Tamo Extension,
Magallanes, Makati City

asia@t-luce.com
+632 8893 2403

T-Luce Italia srl
Viale Giacomo Matteotti 15, Firenze 50121 Italy

info@t-luce.com
+39 3281425503